

LEGEND

- ① #4 REBAR HOOPS (2 EACH) SEE SECTION A-A).
- ② #4 REBAR AT 20" SPACING.
- ③ SCORES.
- ④ RIM.
- ⑤ FRAME AND COVER PER SD-507 AND SD-507A.
- ⑥ SEE "DETAIL A" FOR REBAR IN COLLAR.
- ⑦ FINISHED GRADE.
- ⑧ SEE OTHER STANDARD DRAWINGS OF MANHOLES FOR MAXIMUM HEIGHT.
- ⑨ GROUT BETWEEN RING AND COVER AND GRADE RINGS.
- ⑩ ~~FIBRILLATED POLYPROPYLENE FIBER (ADDED PER MANUFACTURER'S RECOMMENDATIONS) MAY BE USED IN LIEU OF #4 REBAR IN CONCRETE COLLARS.~~ **(REBAR IS REQUIRED)**

NOTE:
 (A) TOP OF COLLAR TO BE FLUSH WITH MANHOLE COVER

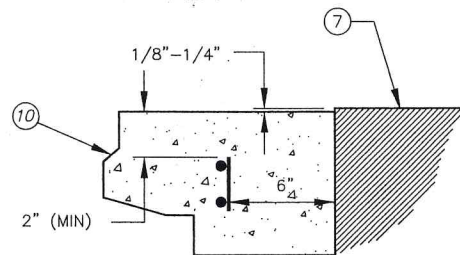

2008 REVISIONS

IDAHO STANDARDS
FOR PUBLIC WORKS
CONSTRUCTION

**MANHOLE
COLLAR**

STANDARD DRAWING
NO. **SD-508**