

PLAN
N.T.S.

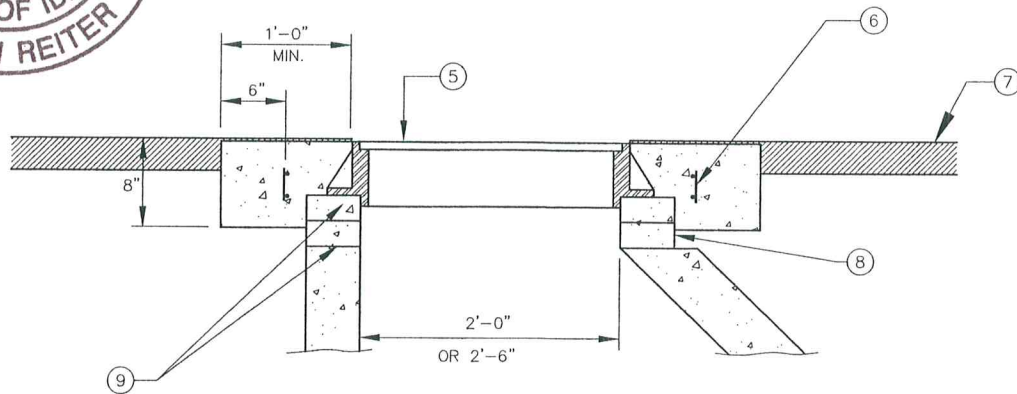

SECTION A-A
N.T.S.

NOTE:

- (A) TOP OF COLLAR TO BE FLUSH WITH MANHOLE COVER

LEGEND

- (1) #4 REBAR HOOPS (2 EACH) SEE SECTION A-A).
- (2) #4 REBAR AT 20" SPACING.
- (3) SCORES.
- (4) RIM.
- (5) FRAME AND COVER PER SD-507 AND SD-507A.
- (6) SEE "DETAIL A" FOR REBAR IN COLLAR.
- (7) FINISHED GRADE.
- (8) SEE OTHER STANDARD DRAWINGS OF MANHOLES FOR MAXIMUM HEIGHT.
- (9) GROUT BETWEEN RING AND COVER AND GRADE RINGS.
- (10) FRIBILLATED POLYPROPYLENE FIBER (ADDED PER MANUFACTURER'S RECOMMENDATIONS) MAY BE USED IN LIEU OF #4 REBAR IN CONCRETE COLLARS.

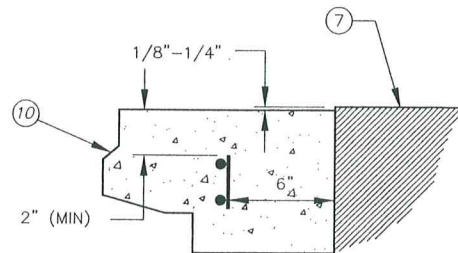

DETAIL A
N.T.S.

2008 REVISIONS

IDAHO STANDARDS
FOR PUBLIC WORKS
CONSTRUCTION

**MANHOLE
COLLAR**

STANDARD DRAWING
NO. **SD-508**